



Series 2804

Zetco Stainless Steel
Needle Valve
NPT Threaded

FEATURES

MANUFACTURED IN TAIWAN (R.O.C.)

HEAVY PATTERN DESIGN

STAINLESS STEEL 316

FORGED TO SHAPE AND MACHINED

SUITABLE FOR APPLICATIONS WHERE FINE FLOW CONTROL IS REQUIRED

ALL VALVES PRESSURE TESTED DURING PRODUCTION

SIZE RANGE: 6MM TO 25MM

PRESSURE AND TEMPERATURE RATINGS

TEMPERATURE RANGE: 0°C TO 200°C

MAXIMUM OPERATING PRESSURE AT NOMINAL TEMPERATURES: 6000 PSI (41,300 kPa)

FOR RATINGS AT SPECIFIC TEMPERATURES REFER TO GRAPH OVERLEAF

Series 2804

Zetco Stainless Steel Needle Valve

NPT Threaded



DIMENSIONAL AND COMPONENT DIAGRAM

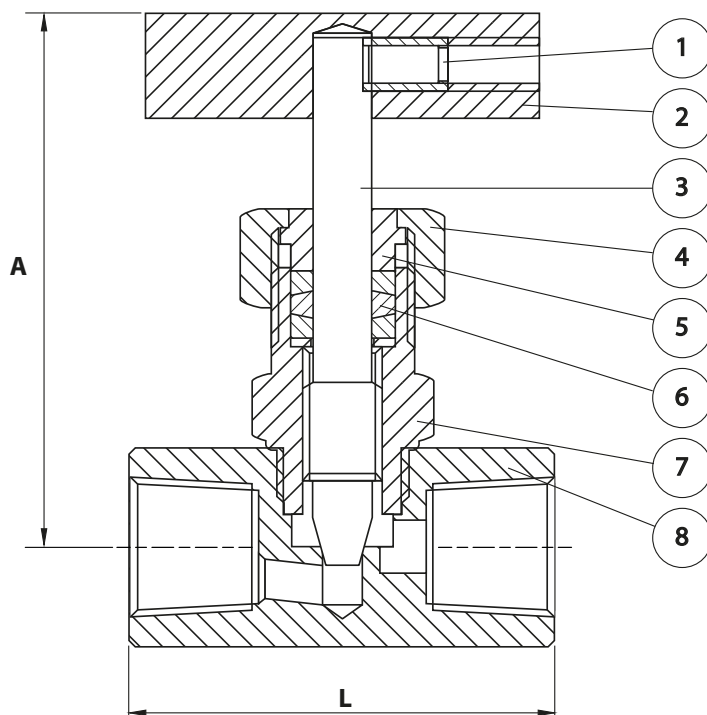

MATERIALS

POS.	PART NAME	MATERIALS
1	SET SCREW	STAINLESS STEEL 304
2	HANDLE	STAINLESS STEEL 410
3	STEM	STAINLESS STEEL 316
4	GLAND NUT	STAINLESS STEEL 304
5	GLAND	STAINLESS STEEL 304
6	PACKING	PTFE
7	BONNET	STAINLESS STEEL 316
8	BODY	STAINLESS STEEL 316

DIMENSIONS - mm

Prod. Code	Size	A	L	Kv	Wgt kg
2804003	3	75	58	0.60	0.404
2804006	6	75	58	0.69	0.383
2804010	10	75	58	0.77	0.365
2804015	15	87	65	1.03	0.563
2804020	20	90	70	1.12	0.712
2804025	25	103	80	1.55	1.29

PRESSURE/TEMPERATURE DIAGRAM

