



## PRODUCT CATALOGUE

# WDS3 & LDS3 Wafer & Lugged Series Resilient Seat Butterfly Valves



**AGA – APPROVED MANUAL & AUTOMATIC**

# Product Code System

<b>L</b>	Lugged
<b>W</b>	Wafer
<b>D</b>	Ductile Iron Body (A395 Gr.60-40-18)
<b>S</b>	CF8M / SS316 Disc
<b>3</b>	NBR (Nitrile) Seat
<b>16</b>	16bar / 1600kPa



## Technical Specification

- Body Styles: Wafer or Lugged
- Face to Face: EN 558 / ISO 5752
- Size Range: 50mm (2") ~ 200mm (8") AGA-approved  
Non-AGA, up to 2000mm (80")
- Flange Ends: Wafer - Universal, suits ANSI 125/150, AS 2129 Table 'E' & 'D', DIN 16 up to 300mm.  
Lugged - AS 2129 Table 'E' & 'D'; ANSI 125/150
- Top Flange: ISO 5211
- Pressure Rating: 1.6 Mpa (1600kPa)
- Pressure Test: ISO 5208-15

	<b>WDS3-16</b> Body: DI A395 Disc: CF8M Liner: NBR Shaft: 1.4021	Flange Standard: ANSI/E/D Max. Pressure: 16 bar Temperature: -10°C+80°C Serial Number: 22/0000
---	--	---

	<b>LDS3-16</b> Body: DI A395 Disc: CF8M Liner: NBR Shaft: 1.4021	Flange Standard: Table E Max. Pressure: 16 bar Temperature: -10°C+80°C Serial Number: 22/0000
---	--	--

	<b>LDS3-16</b> Body: DI A395 Disc: CF8M Liner: NBR Shaft: 1.4021	Flange Standard: ANSI 150 Max. Pressure: 16 bar Temperature: -10°C+80°C Serial Number: 22/0000
---	--	---

## AGA Approvals



Manual Shut-off Class 1  
AS 4617 - 2018  
(Incl Amdt. 1)  
Certificate No. 9020

Automatic Shut-off & Vent  
Valves Class 1  
AS 4629 - 2005  
(Incl. Amdt 1 & 2)  
Certificate No. 9021

Temperature tested by AGA  
-10°C ~ 80°C  
Pressure Tested by AGA  
1.6Mpa (1600kPa)

# Features & Advantages

In comparison to other valve types, technical and economic advantages can be found in the butterfly valve due to its minimum pressure drop and low torque.

From an economical point of view, the best valve is the butterfly valve, as the most important manufacturing costs are: raw material, machining, handling and installation. All these factors make the balance tip towards the butterfly valve.

## Concentric butterfly valves also have the following special technical features:

- Full watertightness is achieved, thanks to a resilient rubber seat liner which gives bidirectional sealing; therefore, gasket joints are unnecessary when assembling between flanges.
- Due to the encircling seat liner system covering inside the body of the valve, the fluid only comes in contact with the seat liner itself and the disc. This seat has no cavities for the retention of line fluid.
- The nature of fluid, pressure, temperature and further factors of the line must be considered when choosing parts in contact with the fluid. Various seat and disc options ensure valves compatibility to line media.
- As the butterfly valve has a weight and assembly dimensions lower than those of other type of valves with the same Nominal Diameter, this makes the transport, handling, assembling, lifting equipment, etc., less expensive. It also requires less room to be stored as well as a lower maintenance and/or repair cost.

**Pressure Temperature Chart**

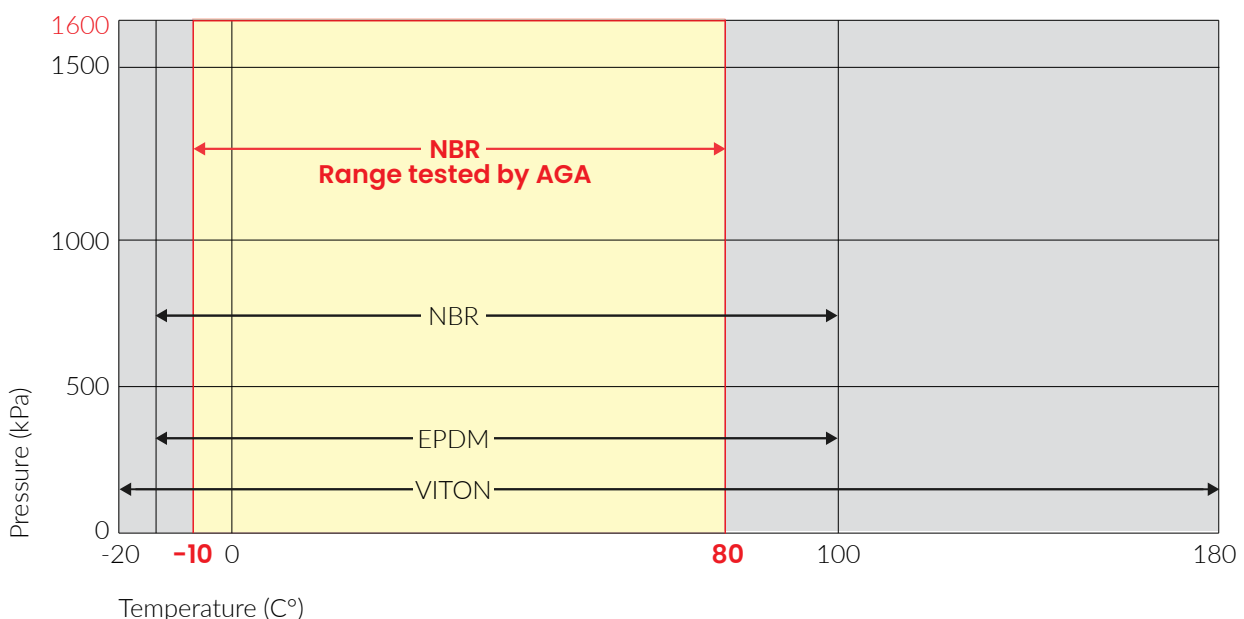

# Particular Attributes of the "Razvalve Series" Resilient Seated Butterfly Valve

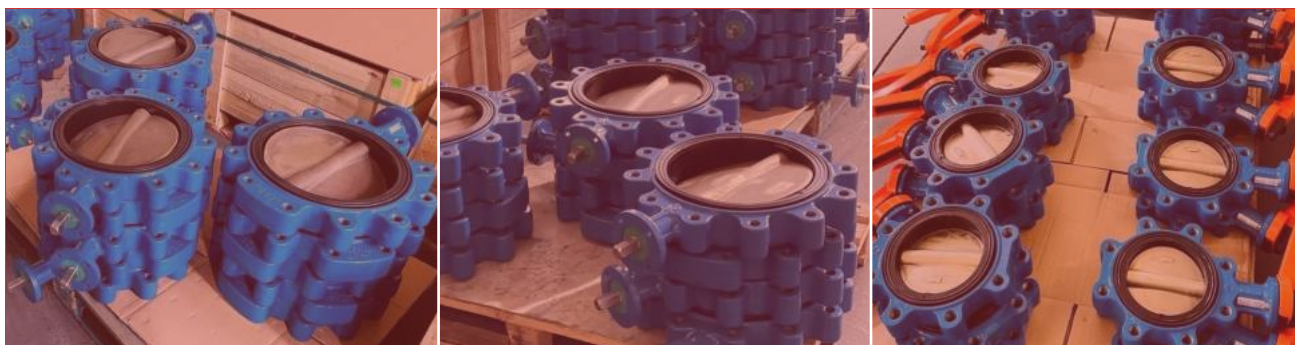

**Our butterfly valves have all the advantages of these types of valves as well as a full warranty for the user, as it is manufactured in compliance with the strictest quality standards set by ISO-EN 9001.**



- Manufactured 100% in Europe - Spain (this includes raw material castings, parts, machining, assembly & testing of manual valves).
- The Rubber Mix NB-70 549 (NBR - Nitrile) for Seat Liners has been developed specifically for Gas usage based on the requirements 549 A2 regulation and certified by Industrias Del Caucho A.R.H., S.L., Madrid, Spain.
- Coating & Valve Body Protection ensuring long service life. All bodies are sand blasted and degreased, to ensure a perfect coating or paint adhesion. All bodies are coated with RILSAN®, polyamide B-11 blue (approx. RAL 5010) with an approximate paint thickness of 250 um. Rilsan® is also resistant to sea water corrosion and is a coating for products to be in contact with drinking water, intended for human consumption.
- Light weight for operational efficiency in piping.
- Fast assembly and disassembly.
- Minimum pressure drop.
- Easy and safe to use.
- Bi-directional bubble-tight sealing.

## Our valves have other additional advantages, such as:

- Total and permanent watertightness up to 16 bar.
- No gaskets necessary for installation between flanges.
- Stem Chevron Seal exclusive design, for external & internal leak prevention.
- Stem retention bushing eliminates blow-out proof stems & OH&S issues.
- Maintenance free.
- Liners easy to replace.
- Due to the Disc - Shaft connection design with no pins, screws or keys and tight machining tolerances of its components, all parts of the valve are interchangeable.
- Extreme low operating torques which extends valve service life and economic selection of actuation.
- Possibility to use it as control (regulating) valve.
- Self-cleaning.
- Cavity free.
- Centering holes enable correct alignment and fast installation, with easy assembly in the pipeline.
- Levers are fitted with notch plates and can be locked in various positions.
- Integral ISO 5211 actuator mounting flange allows for actuator or gearbox fitment.
- Enables the use of insulation in heat-resistant installations.
- Quality identification for material: each Body, Disc and Liner is marked with its code number to have a perfect quality traceability of the materials used for their production. Thus with the Heat Number our Quality Assurance Department obtain a perfect traceability of the quality of materials, enabling them to know at any time the chemical composition and mechanical properties.
- Descriptive label indicating: name of manufacturer, valve figure description, maximum working pressure, maximum working temperature, flange standard and country of origin (see page 2).
- Thermo-contractive polyethylene individually packaged valves for reduced damage in transport and storage.



## Valve Design & Parts

Nylon-6 Retention Bushing

BUNA-N Chevron Seal

Rilsan Coated DI Body

NBR Nitrile Seat

SS CF8M Disc

1-Pce SS Shaft

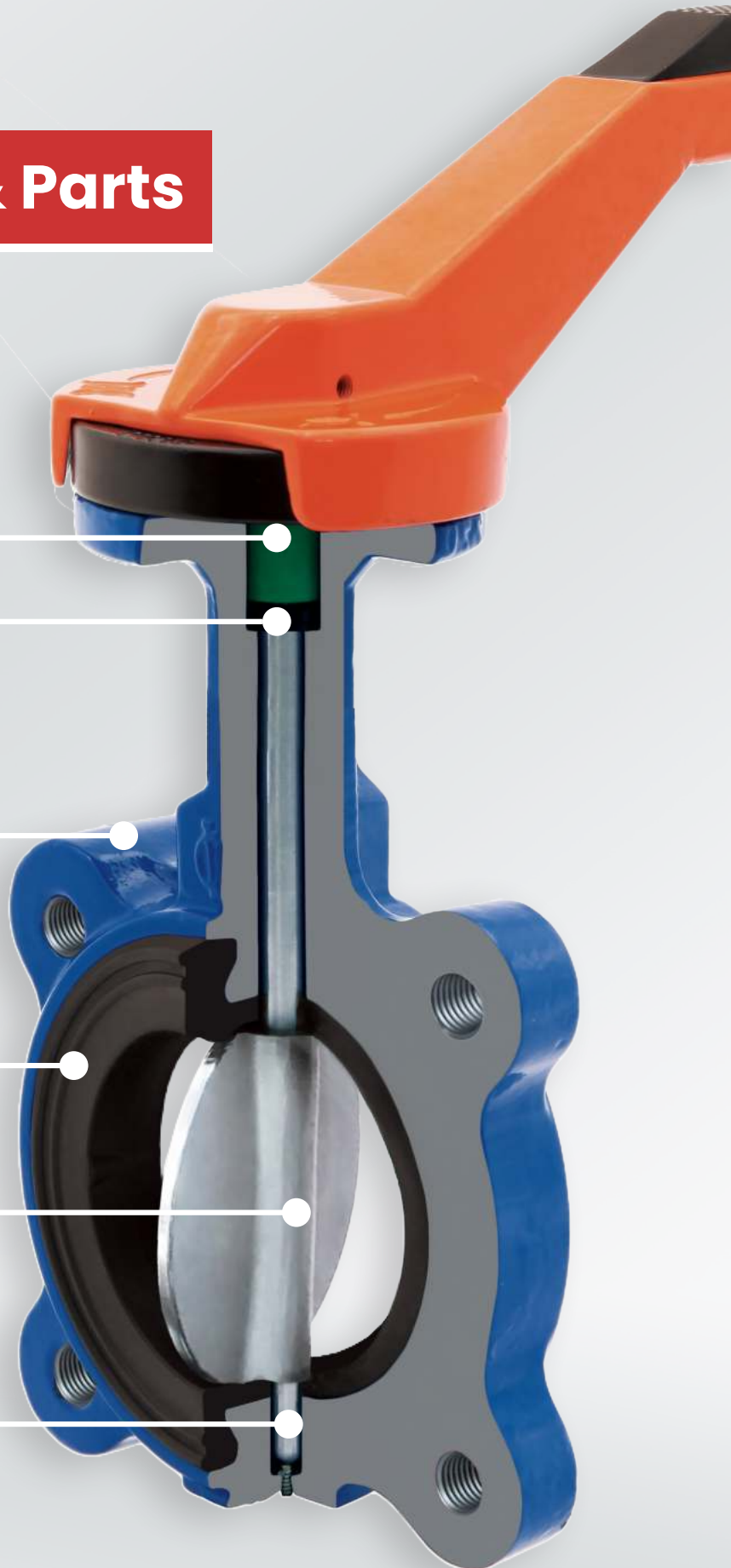

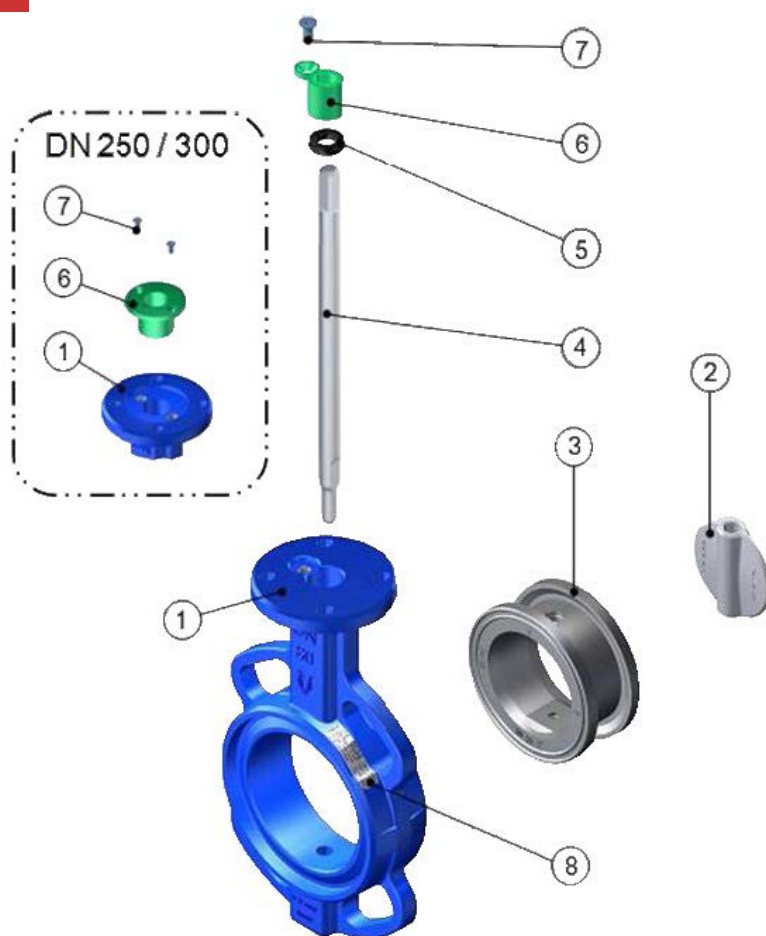

**Rilsan Coated**

Ductile Iron Body

**Chevron-Type**

Body/Shaft Seal

**SS CF8M Disc****Nylon-6 Retention Bushing**

Retention Bushing

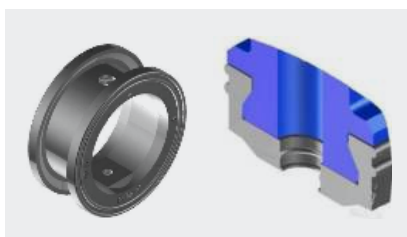
**NBR - Nitrile Seat**

Fully Machined Fit to Valve Body

**1-Pce SS Stem**

Item	Description	Materials	Quantity
1	Body	Ductile Iron	1
2	Disc	CF8M / 316SS	1
3	Seat	NBR - Nitrile	1
4	Shaft	Stainless Steel	1
5	Chevron Seal	BUNA-N	1
6	Retention Bushing	NYLON-6	1
7	Bolt For Retention Bushing (DIN - 7991)	Stainless Steel	(*)
8	Label with Data	PVC	1

(\*) Up to DN-200, quantity 1. For DN-250 and DN-300, quantity 2.

# AGA Certificates & Tagging

**AGA CERTIFIED PRODUCT**

Certificate Holder: **RAZVALVE PACIFIC PTY LTD**

ABN/ACN No. (if applicable): 76 132 617 399

Agent (if applicable): N/A

Type of Component: **Manually Operated Shut-Off Valve Type 1, Butterfly Valve**

Model No. & Description: **Razvalve Model: LDS3-16 Series: DN: 50mm, 65mm, 80mm, 100mm, 125mm, 150mm & 200mm.**

**WDS3-16 Series: DN: 50mm, 65mm, 80mm, 100mm, 125mm, 150mm & 200mm.**

Working Pressure rating: 1,600kPa  
Working Temperature Range: -10°C~80°C

Relevant Standard(s): **AS 4617 – 2018 (Inc. Amendment 1)**

## Manual Valve Lever Handle Data

Made in Spain



**AGA CERTIFICATE No. AGA 9020 G**  
**AS 4617 – 2018 (Incl. Amd. 1)**  
**Max. Pressure: 16 bar**  
**Temperature: -10°C+80°C**

This is to certify that the particular **COMPONENT** specifically described herein and supplied to The Australian Gas Association (hereafter called the AGA) by the Certificate Holder named above has been subject to "type-testing" and assessed by the AGA to comply with the requirements of the AGA's Product Certification Scheme for Type Tested Gas Products.

This Certificate is issued on the express conditions that:

- The Certificate Holder undertakes to comply with the Rules Governing The AGA's Product Certification Scheme (hereafter called the Rules Governing);
- This Certificate remains the property of the AGA; and
- The AGA reserves the right to cancel this Certificate in accordance with the Rules Governing; and in such an event the Certificate Holder undertakes to surrender the Certificate to the AGA upon request.



T. Tong

Client Manager

Dem

Certificate Authorised

Certificate first issued: **19 December 2022**

Certificate No: **9020**

This copy valid from: **19 December 2022**

Refer specification issue: **01**

This Certificate issued by The Australian Gas Association ABN 98 004 200 044



## AGA CERTIFIED PRODUCT

Certificate Holder: **RAZVALVE PACIFIC PTY LTD**

ABN/ACN No. (if applicable): 76 132 617 399

Agent (if applicable): N/A

Type of Component: **Automatic Shut-Off or Vent Valve, Class 1**

Model No. & Description: **Razvalve**  
(Refer [www.aga.asn.au](http://www.aga.asn.au) for more details)

**Model: LDS3-16 Series: DN: 50mm, 65mm, 80mm, 100mm, 125mm, 150mm & 200mm.**

**WDS3-16 Series: DN: 50mm, 65mm, 80mm, 100mm, 125mm, 150mm & 200mm.**

Working Pressure rating: 1,600kPa, Working Temperature Range: -10°C~80°C

Actuator: EA-SRXXX Series  
Solenoid Options: Burnout ES29 & ES38 Series & Power-Genes: ESV-S Series  
Valve position monitor with built-in solenoid valve (without override):  
Power-Genes: LSB-7000 Series (with built-in Solenoid valve)  
Valve position monitor: optional  
Power-Genes: LSB3000 series, ACHER: ALS-200M2, ALS400M2, ALS-500M2 & ALS-500M22 series  
Air filter regulator & gauge: Optional: Shako, Norgren, SMC  
Air Relief valve: Optional: Swagelok, Norgren, SMC

Relevant Standard(s): **AS 4629 – 2005 (Inc. Amendment 1&2)**

This is to certify that the particular **COMPONENT** specifically described herein and supplied to The Australian Gas Association (hereafter called the AGA) by the Certificate Holder named above has been subject to "type-testing" and assessed by the AGA to comply with the requirements of the AGA's Product Certification Scheme for Type Tested Gas Products.

This Certificate is issued on the express conditions that:

- The Certificate Holder undertakes to comply with the Rules Governing The AGA's Product Certification Scheme (hereafter called the Rules Governing);
- This Certificate remains the property of the AGA; and
- The AGA reserves the right to cancel this Certificate in accordance with the Rules Governing; and in such an event the Certificate Holder undertakes to surrender the Certificate to the AGA upon request.



T. Tong

Client Manager

Dem

Certificate Authorised

Certificate first issued: **12 January 2023**

Certificate No: **9021**

This copy valid from: **12 January 2023**

Refer specification issue: **01**

This Certificate issued by The Australian Gas Association ABN 98 004 200 044

## Automatic Valve Name Plate Data



Australian Standard AS 4629-2005 (Amdt 1 & 2)  
**AGA Certificate No. AGA 9021 G**

- ☐ Automatic Shut-off Valves, Class 1  
☐ Automatic Vent Valves, Class 1

Razvalve Butterfly Model: <input type="checkbox"/> LDS3-16 <input type="checkbox"/> WDS3-16	
Ends: <input type="checkbox"/> Lugged <input type="checkbox"/> 150 <input type="checkbox"/> E <input type="checkbox"/> D	<input type="checkbox"/> Wafer 150#, E, D
Serial No: _____	M/Y: _____ P/T: <input type="checkbox"/> 1600kPa / -10°C~80°C
Emico Actuator: EA-SR <input type="checkbox"/> AFR <input type="checkbox"/> ARV	
Solenoid: <input type="checkbox"/> 6519 <input type="checkbox"/> ESV <input type="checkbox"/> LSB-7000 <input type="checkbox"/> GP <input type="checkbox"/> EX	
Limit Switch: ALS- <input type="checkbox"/> 400M2 <input type="checkbox"/> 500M2 <input type="checkbox"/> 200M2 / LSB- <input type="checkbox"/> 3000 <input type="checkbox"/> 7000	



03 9764 1149



# Butterfly Valve Actuation Details

- Razvalve WDS3-16 & LDS3-16 Wafer & Lugged Butterfly valves fitted with Spring Return Pneumatic Actuators.
- Razvalve butterfly valves have ISO 5211 mounting pads for actuation.
- Valves have actuators sized for full rated valve line pressure of 1600kPa, and based on 550kPa air supply.
- Automatic butterfly valve packages are available for Shut-off as well as Vent applications.
- Minimum 50% safety factor has been considered for gas sizing applications.
- Direct mount of actuators using conversion flange & bolting.
- Actuators have NAMUR-standard air connections and accessory mounts. Also available for piped connections depending on solenoid option fitted.
- Bolt-on accessories include solenoid valves, limit switches, air filter regulators, air relief valve. Available in various power voltages and Explosion Proof, Intrinsically Safe & General Purpose.



RAZVALE Butterfly Valves		Actuator Model	Solenoid Valve	Limit Switch	Others
Part No.	Size (mm)	Spring Return	3/2-Way		
WDS3-16 LDS3-16	50	EA-SR75/11	6519 / ESV-S	LSB-3000 / LSB-7000 / ALS-200M2	Filter Regulator / Relief Valve
	65	EA-SR83/11			
	80	EA-SR92/10			
	100	EA-SR105/11			
	125	EA-SR105/12			
	150	EA-SR125/10			
	200	EA-SR160/11			

Refer to Drawings and Technical Bulletin for detailed information.



# Manual Valve Dimensional Drawings



## Wafer Design Lever Operated WDS3-16

**LEVER WITH 9 INTERMEDIATE POSITIONS AND LOCKING DEVICE**

ISO-5752/20  
EN 558/20

STANDARD FLANGES ASSEMBLY

MAX. PRESS.  
16 BAR

SCREW TO LOCK  
THE LEVER WITH THE SHAFT

DISC HEAT NUMBER

SEAT BATCH NUMBER

BODY MATERIAL CODE

DISC MATERIAL CODE

SEAT MATERIAL CODE

BODY HEAT NUMBER

LOCKING DEVICE  
(PADLOCK NOT INCLUDED)  
MAX. DIAM. 4,5mm

VALVES DESIGNED TO SUIT EITHER  
DN PN4/10/16, ASME B16.5 150 Lbs. 6 B.S. 10-0/16  
(ANY OTHER STANDARD ON REQUEST)

POS.	QTY.	DENOMINATION	MATERIAL
1	1	BODY	AS PER ORDER
2	1	DISC	AS PER ORDER
3	1	SEAT	AS PER ORDER
4	1	TORSION SHAFT	STAINLESS STEEL
5	1	"CHEVRON" SHAFT SEAL	BUNA-N
6	1	RETENTION BUSHING	NYLON-6 NATURAL
7	1	BOLT FOR RETENTION BUSHING (DN - 7991)	STAINLESS STEEL
8	1	LEVER	ALUMINUM EPOXY PAINTED
9	1	NOTCH PLATE	ALUMINUM EPOXY PAINTED
10	2	WASHER (DN - 6798/A)	STAINLESS STEEL
11	2	ASSEMBLY BOLT (DN - 912)	STAINLESS STEEL
12	1	LABEL WITH FEATURES	PVC

NOMINAL DIAMETER	VALVE GENERAL DIMENSIONS					ACTUATOR GENERAL DIMENSIONS					WEIGHT (Kg)	"Q"	
	A	B	Ø C	E	J	K	Ø L	M	N	P			
50	2"	140	83	102	43	45	210	90	26	62	30	3,7	31
65	2 1/2"	152	93	122	46	45	210	90	26	62	30	4,4	31
80	3"	159	98	130	48	45	210	90	26	62	30	4,7	31
100	4"	178	111	159	52	45	210	90	26	62	30	6,1	30

SET: BUTTERFLY VALVE WDS 3-16 DN. 50 400 (2" - 4") DESIGNED BY: U.S.G.

DENOMINATION: REF.: S.100-P/15 CHECKED BY: J.B.F.

DRAWING NUMBER: REV.: 00 DATE: 17-02-21 SCALE: ACTUATOR: WEIGHT (lbs.): APPROVED BY: V.A.G.

Bench marks in mm

**LEVER WITH 10 INTERMEDIATE POSITIONS AND LOCKING DEVICE**

ISO-5752/20  
EN 558/20

STANDARD FLANGES ASSEMBLY

MAX. PRESS.  
16 BAR

REMOVE PLASTIC COVER TO  
ACCESS THE LEVER LOCKING  
SCREW WITH THE TORSION SHAFT.  
USE 5mm ALLEN WRENCH.  
THEN PUT THE PLASTIC COVER IN  
PLACE.

SEAT BATCH NUMBER

DISC HEAT NUMBER

DISC MATERIAL CODE

SEAT MATERIAL CODE

BODY HEAT NUMBER

BODY MATERIAL CODE

LOCKING DEVICE  
(PADLOCK NOT INCLUDED)  
MAX. DIAM. 8mm

VALVES DESIGNED TO SUIT EITHER  
DN PN4/10/16, ASME B16.5 150 Lbs. 6 B.S. 10-0/16  
(ANY OTHER STANDARD ON REQUEST)

POS.	QTY.	DENOMINATION	MATERIAL
1	1	BODY	AS PER ORDER
2	1	DISC	AS PER ORDER
3	1	SEAT	AS PER ORDER
4	1	TORSION SHAFT	STAINLESS STEEL
5	1	"CHEVRON" SHAFT SEAL	BUNA-N
6	1	RETENTION BUSHING	NYLON-6 NATURAL
7	1	BOLT FOR RETENTION BUSHING (DN - 7991)	STAINLESS STEEL
8	1	LEVER	ALUMINUM POLYESTER PAINTED
9	2	ASSEMBLY BOLT (DN - 933)	STAINLESS STEEL
10	2	WASHER (DN - 6798/A)	STAINLESS STEEL
11	2	NUT (DN - 934)	STAINLESS STEEL
12	1	LABEL WITH FEATURES	PVC

NOMINAL DIAMETER	VALVE GENERAL DIMENSIONS					ACTUATOR GENERAL DIMENSIONS					WEIGHT (Kg)	"Q"	
	A	B	Ø C	E	J	K	Ø L	M	N	P			
125	5"	191	127	189	56	45	320	100	25	95	58	8,2	116
150	6"	203	143	214	56	45	320	100	25	95	58	9,7	143
200	8"	245	172	269	60	45	320	100	25	95	58	14,3	105

SET: BUTTERFLY VALVE WDS 3-16 DN. 125 - 200 (5" - 8") DESIGNED BY: U.S.G.

DENOMINATION: REF.: S.100-P/17 CHECKED BY: J.B.F.

DRAWING NUMBER: REV.: 00 DATE: 17-02-21 SCALE: ACTUATOR: WEIGHT (lbs.): APPROVED BY: V.A.G.

Bench marks in mm

## Lugged Design Lever Operated LDS3-16

**LEVER WITH 9 INTERMEDIATE POSITIONS AND LOCKING DEVICE**

(ISO-5752/20)  
(EN 558/20)

SCREW TO LOCK THE LEVER WITH THE SHAFT

SEAT BATCH NUMBER

DISC HEAT NUMBER

BODY MATERIAL CODE

DISC MATERIAL CODE

SEAT MATERIAL CODE

BODY HEAT NUMBER

THREAD

LOCKING DEVICE (PADLOCK NOT INCLUDED)  
MAX. DIAM. 4.5mm

POS. QTY.		DENOMINATION		MATERIAL	
1	1	BODY	AS PER ORDER		
2	1	DISC	AS PER ORDER		
3	1	SEAT	AS PER ORDER		
4	1	TORSION SHAFT	STAINLESS STEEL		
5	1	"CHEVRON" SHAFT SEAL	BUNA-N		
6	1	RETENTION BUSHING	NITRONE NATURAL		
7	1	BOLT FOR RETENTION BUSHING (DN > 750)	STAINLESS STEEL		
8	1	LEVER	ALUMINUM POLYESTER PAINTED		
9	1	WASHER (DN > 675)	STAINLESS STEEL		
10	2	WASHER (DN > 675)	STAINLESS STEEL		
11	2	ASSEMBLY BOLT (DN > 675)	STAINLESS STEEL		
12	1	LABEL WITH FEATURES	PVC		

NOMINAL DIAMETER		EN 1092-142 PN10		EN 1092-142 PN16		ASME B16.5 150 Lbs.	
mm	Inch	THREAD	G" x Ø1	THREAD	G" x Ø1	THREAD	G" x Ø1
50	2"	M10	3/8 x 1.5	M10	3/8 x 1.5	3/4" UNC 1/4"	30
65	2 1/2"	M10	3/8 x 1.5	M10	3/8 x 1.5	3/4" UNC 1/4"	30
80	3"	M10	3/8 x 1.5	M10	3/8 x 1.5	3/4" UNC 1/4"	30
100	4"	M10	3/8 x 1.5	M10	3/8 x 1.5	3/4" UNC 1/4"	30

NOMINAL DIAMETER		VALVE GENERAL DIMENSIONS		ACTUATOR GENERAL DIMENSIONS		WEIGHT (Kg)		"Q"	
mm	Inch	A	B	C	E	J	K	L	M
50	2"	140	56	152	43	45	210	90	26
65	2 1/2"	152	63	178	46	45	210	90	26
80	3"	158	71	171	46	45	210	90	26
100	4"	178	87	229	52	45	210	90	26

SET: BUTTERFLY VALVE LDS 3-16 DN 50 - 100 (2" - 4") DESIGNED BY: U.S.G.

DENOMINATION: LUG TYPE REF: S.500-P/11 CHECKED BY: J.B.F.

DRAWING NUMBER: L-011 REV: 00 DATE: 17-02-21 SCALE: ACTUATOR: LEVER WEIGHT (Lbs.): SEE TABLE APPROVED BY: V.A.G.

Bench marks in mm

**LEVER WITH 10 INTERMEDIATE POSITIONS AND LOCKING DEVICE**

(ISO-5752/20)  
(EN 558/20)

REMOVE PLASTIC COVER TO ACCESS THE LEVER LOCKING SCREW WITH THE TORSION SHAFT. USE 5mm ALLEN WRENCH. THEN PUT THE PLASTIC COVER IN PLACE.

SEAT BATCH NUMBER

DISC HEAT NUMBER

BODY MATERIAL CODE

DISC MATERIAL CODE

SEAT MATERIAL CODE

BODY HEAT NUMBER

THREAD

LOCKING DEVICE (PADLOCK NOT INCLUDED)  
MAX. DIAM. 8mm

POS. QTY.		DENOMINATION		MATERIAL	
1	1	BODY	AS PER ORDER		
2	1	DISC	AS PER ORDER		
3	1	SEAT	AS PER ORDER		
4	1	TORSION SHAFT	STAINLESS STEEL		
5	1	"CHEVRON" SHAFT SEAL	BUNA-N		
6	1	RETENTION BUSHING	NITRONE NATURAL		
7	1	BOLT FOR RETENTION BUSHING (DN > 750)	STAINLESS STEEL		
8	1	LEVER	ALUMINUM POLYESTER PAINTED		
9	2	ASSEMBLY BOLT (DN > 675)	STAINLESS STEEL		
10	2	WASHER (DN > 675)	STAINLESS STEEL		
11	2	NUT (DN > 675)	STAINLESS STEEL		
12	1	LABEL WITH FEATURES	PVC		

NOMINAL DIAMETER		EN 1092-142 PN10		EN 1092-142 PN16		ASME B16.5 150 Lbs.	
mm	Inch	THREAD	G" x Ø1	THREAD	G" x Ø1	THREAD	G" x Ø1
125	5"	M10	3/8 x 1.5	M10	3/8 x 1.5	3/4" UNC 1/4"	30
150	6"	M10	3/8 x 1.5	M10	3/8 x 1.5	3/4" UNC 1/4"	30
200	8"	M10	3/8 x 1.5	M10	3/8 x 1.5	3/4" UNC 1/4"	30

NOMINAL DIAMETER		VALVE GENERAL DIMENSIONS		ACTUATOR GENERAL DIMENSIONS		WEIGHT (Kg)		"Q"	
mm	Inch	A	B	C	E	J	K	L	M
125	5"	191	102	254	56	45	320	100	25
150	6"	203	122	260	56	45	320	100	25
200	8"	245	171	318	60	45	320	100	25

SET: BUTTERFLY VALVE LDS 3-16 DN 125 - 200 (5" - 8") DESIGNED BY: U.S.G.

DENOMINATION: LUG TYPE REF: S.500-P/13 CHECKED BY: J.B.F.

DRAWING NUMBER: L-013 REV: 00 DATE: 17-02-21 SCALE: ACTUATOR: LEVER WEIGHT (Lbs.): SEE TABLE APPROVED BY: V.A.G.

Bench marks in mm



## Wafer WDS3-16 & Lugged LDS3-16 Lever Operated Bare Stem

**RAZVALVE MODEL: WDS3-16**

VALVES DESIGNED TO SUIT EITHER  
DN PN10/16, ASME B16.5 TOLLS OR B.S. 1500E  
(ANY OTHER STANDARD ON REQUEST)

POS.	QTY.	DENOMINATION	MATERIAL
1	1	BODY	AS PER ORDER
2	1	DISC	AS PER ORDER
3	1	SEAT	AS PER ORDER
4	1	TORSION SHAFT	STAINLESS STEEL
5	1	"CHEVRON" SHAFT SEAL	BUNA-N
6	1	RETENTION BUSHING	NYLON4 (NATURAL)
7	1	BOLT FOR RETENTION BUSHING (DN - 700)	STAINLESS STEEL
8	1	LABEL WITH FEATURES	PVC

NOMINAL DIAMETER	GENERAL DIMENSIONS										ACTUATOR ASSEMBLY ACCORDING TO ISO-5211										WEIGHT (kg)	"Q" AT 16 bar (Nm)	TORQUE AT 16 bar (Nm)							
	mm	in.	A	B	C	D	E	F	G	H	I	J	K	L	M	N	O	P	Q	R				S	T	U	V	W	X	Y
50	2"	140	80	102	12	43	F-07	8	70	80	26	132	11	3.3	31	15														
65	2 1/2"	160	90	122	12	46	F-07	9	70	90	26	132	11	4	31	20														
80	3"	160	90	130	12	46	F-07	9	70	90	26	132	11	4.3	30	25														
100	4"	178	111	128	14	52	F-07	8	70	80	30	168	14	5.7	80	45														
125	5"	191	127	138	14	56	F-07	8	70	80	30	168	14	7.4	116	50														
150	6"	203	143	154	15	58	F-07	9	70	90	33	204	17	8.9	145	60														
200	8"	245	172	200	15	60	F-07	8	70	80	33	204	17	13.5	165	100														
250	10"	275	204	231	17	68	F-10	11	102	125	70	3	47	28	22	243	250													
300	12"	315	242	260	17	78	F-10	11	102	125	70	3	47	28	22	117	250	300												

SET: BUTTERFLY VALVE DN 50 - 300 (2" - 12") DESIGNED BY: J.J.G.

DENOMINATION: WAFFER IYPF REF: S.100-E/01 CHECKED BY: A.S.M.

DRAWING NUMBER: W-001 REV: 00 DATE: 17-11-15 SCALE: - ACTUATOR: BARE SHAFT WEIGHT (lbs.): SEE TABLE APPROVED BY: V.A.G.

Bench marks in mm

**RAZVALVE MODEL: LDS3-16**

VALVES DESIGNED TO SUIT EITHER  
DN PN10/16, ASME B16.5 TOLLS OR B.S. 1500E  
(ANY OTHER STANDARD ON REQUEST)

POS.	QTY.	DENOMINATION	MATERIAL
1	1	BODY	AS PER ORDER
2	1	DISC	AS PER ORDER
3	1	SEAT	AS PER ORDER
4	1	TORSION SHAFT	STAINLESS STEEL
5	1	"CHEVRON" SHAFT SEAL	BUNA-N
6	1	RETENTION BUSHING	NYLON4 (NATURAL)
7	1	BOLT FOR RETENTION BUSHING (DN - 700)	STAINLESS STEEL
8	1	LABEL WITH FEATURES	PVC

NOMINAL DIAMETER	GENERAL DIMENSIONS										ACTUATOR ASSEMBLY ACCORDING TO ISO-5211										WEIGHT (kg)	"Q" AT 16 bar (Nm)	TORQUE AT 16 bar (Nm)							
	mm	in.	A	B	C	D	E	F	G	H	I	J	K	L	M	N	O	P	Q	R				S	T	U	V	W	X	Y
50	2"	140	80	102	12	43	F-07	8	70	80	26	132	11	3.3	31	15														
65	2 1/2"	160	90	122	12	46	F-07	9	70	90	26	132	11	4	31	20														
80	3"	160	90	130	12	46	F-07	9	70	90	26	132	11	4.3	30	25														
100	4"	178	111	128	14	52	F-07	8	70	80	30	168	14	5.7	80	45														
125	5"	191	127	138	14	56	F-07	8	70	80	30	168	14	7.4	116	50														
150	6"	203	143	154	15	58	F-07	9	70	90	33	204	17	8.9	145	60														
200	8"	245	172	200	15	60	F-07	8	70	80	33	204	17	13.5	165	100														
250	10"	275	204	231	17	68	F-10	11	102	125	70	3	47	28	22	243	250													
300	12"	315	242	260	17	78	F-10	11	102	125	70	3	47	28	22	117	250	300												

SET: BUTTERFLY VALVE DN 50 - 300 (2" - 12") DESIGNED BY: J.J.G.

DENOMINATION: LUG TYPE REF: S.500-E/01 CHECKED BY: A.S.M.

DRAWING NUMBER: L-001 REV: 00 DATE: 12-01-12 SCALE: - ACTUATOR: BARE SHAFT WEIGHT (lbs.): SEE TABLE APPROVED BY: V.A.G.

Bench marks in mm



## Also Available

### Large Diameter up to 2000mm



### Flanged Butterfly Valves

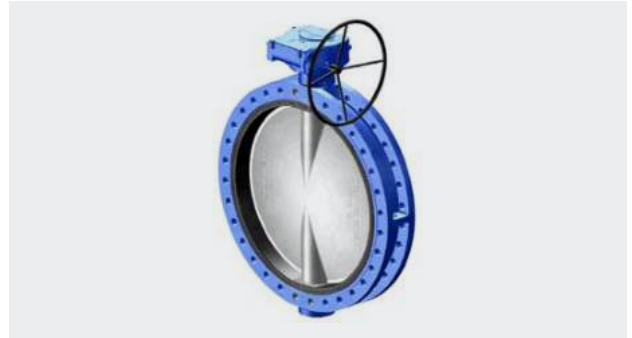

### Electrically Operated



### Lined Butterfly valves





RESILIENT SEAT BUTTERFLY VALVES



## RAZVALVE PACIFIC PTY LTD

Office: Unit 13, 28 Enterprise Drive, Rowville, Victoria 3178, Australia

Warehouse 1: Unit 13, 28 Enterprise Drive, Rowville, Victoria 3178, Australia

Warehouse 2: Unit 2, 28 Enterprise Drive, Rowville, Victoria 3178, Australia

Postal Address: PO Box 4251, Knox City Centre, Victoria 3152, Australia

## CONTACT US

**P:** +61 3 9764 1149

**E:** [sales@razvalve.com](mailto:sales@razvalve.com)

**W:** [razvalve.com](http://razvalve.com)